

Technical data sheet

Product features



Pot and pan washer double skin with drain pump heat recovery system 70x70 - 400 V

Model	SAP Code	00011974
S 202 REC ABT	A group of articles - web	Undercounter, continuous and black ware dishwasher



- To the product for free: 1x RM Clean+ 12 kg (00012271) and 1x RM Rinse+ 10 kg (00012273)
- Display type: LCD multifunction display
- Number of programs: 11
- Number of skin: 2
- Door clear height [mm]: 850
- Rack size [mm]: 700 x 700
- Water consumption of the washing cycle [l/basket]: 4
- Detergent and rinse pump system: ProDose - accurate dosing with a peristaltic pump
- Wash pump type: two-way - DuoFlow
- Self-cleaning cycle: Yes
- Drain filter: Evolution3 - double filtration with electronically controlled partial discharge before the rinsing phase ensures 0% loss of clean water to waste

SAP Code	00011974	Boiler capacity [l]	12.00
Net Width [mm]	850	Boiler power [kW]	8.000
Net Depth [mm]	850	Basin volume [l]	68
Net Height [mm]	2187	Tank power [kW]	8.000
Net Weight [kg]	207.00	Water consumption of the washing cycle [l/basket]	4
Power electric [kW]	18.700	Door clear height [mm]	850
Loading	400 V / 3N - 50 Hz	Rack size [mm]	700 x 700

Technical data sheet

Technical drawing



Pot and pan washer double skin with drain pump heat recovery system 70x70 - 400 V

Model	SAP Code	00011974
S 202 REC ABT	A group of articles - web	Undercounter, continuous and black ware dishwasher

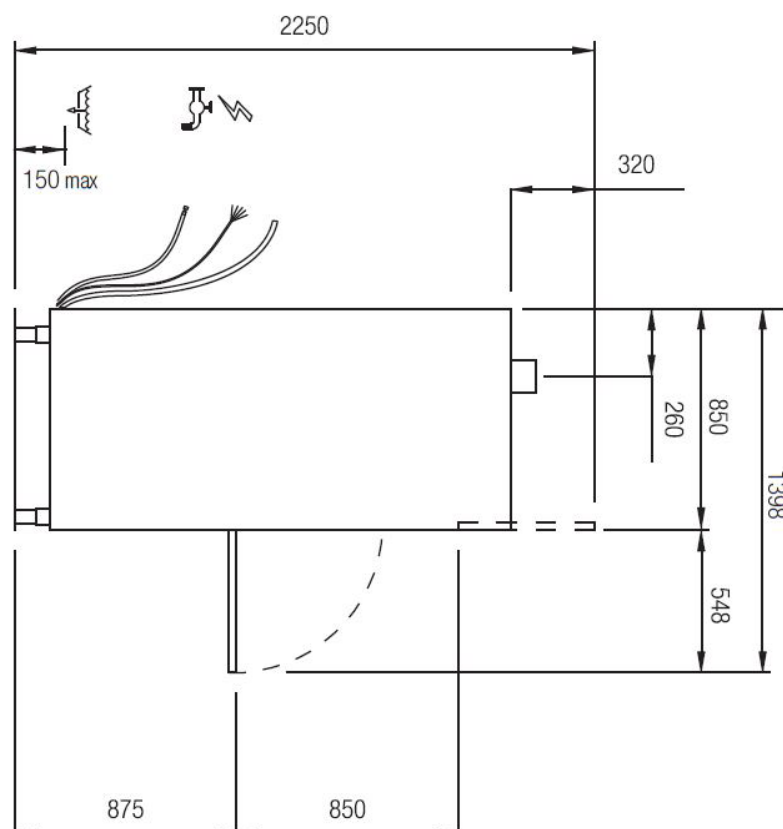
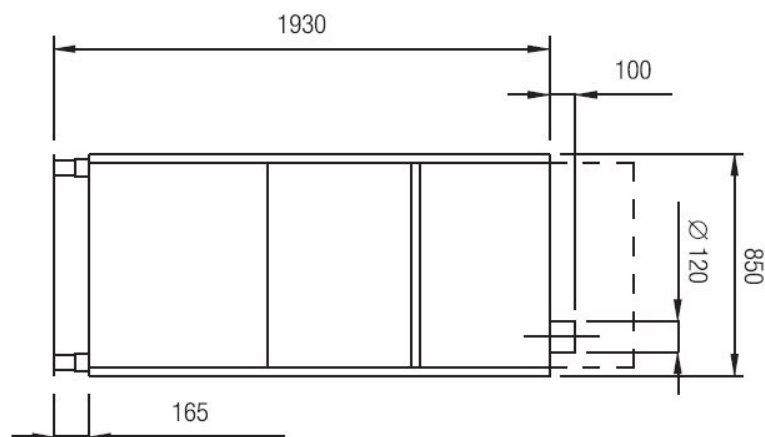

Technical data sheet

Product benefits



Pot and pan washer double skin with drain pump heat recovery system 70x70 - 400 V

Model	SAP Code	00011974
S 202 REC ABT	A group of articles - web	Undercounter, continuous and black ware dishwasher

1

Stainless steel outer shell construction

round construction with stainless steel, rounded edges, Deep-drawn bathtub

2

Stainless steel washing arms

upper and lower arms with stainless steel, separated for washing and rinsing, triple upper arm

3

LED Display

smartScreen, a large color graphic display showing the washing progress

4

Double pump

unique two-way DuoFlow pump

5

Detergent dispensers

two detergent and rinse aid dispensers

6

Double filter system

the chamber filter and the waste filter together with the ArchiMedes system provide a discharge system with increased water purification efficiency

7

Energy saving

energy saving energy saving system due to lowering the temperature of the boiler

8

Protection of fragile dishes

softstart system for gradual start of washing programs to protect fragile dishes

9

Double shell construction

stainless steel construction with insulated double jacket

10

Fast heating

performance management allows the current running of the boiler and basins body

11

Air break tank

the open system of the boiler rinse, in cooperation with the rinse pump, ensures a constant pressure and temperature of the rinse

12

Possibility of recovery

saving up to 40% of boiler energy
improves the comfort environment of the workplace
environment without steam
saves water

Technical data sheet

Technical parameters



Pot and pan washer double skin with drain pump heat recovery system 70x70 - 400 V

Model	SAP Code	00011974
S 202 REC ABT	A group of articles - web	Undercounter, continuous and black ware dishwasher

1. SAP Code:

00011974

2. Net Width [mm]:

850

3. Net Depth [mm]:

850

4. Net Height [mm]:

2187

5. Net Weight [kg]:

207.00

6. Gross Width [mm]:

1000

7. Gross depth [mm]:

950

8. Gross Height [mm]:

2200

9. Gross Weight [kg]:

217.00

10. Device type:

Electric unit

11. Control type:

Digital

12. Material:

AISI 304

13. Power electric [kW]:

18.700

14. Loading:

400 V / 3N - 50 Hz

15. Number of programs:

11

16. Opening of device:

Tilting down

17. Door clear height [mm]:

850

18. Inlet pressure [bar]:

1-6

19. Adjustable feet:

Yes

20. Number of skin:

2

21. Self-cleaning cycle:

Yes

22. Boiler capacity [l]:

12.00

23. Boiler power [kW]:

8.000

24. Basin volume [l]:

68

25. Tank power [kW]:

8.000

26. Number of arms for both rinsing and washing:

2

27. Arm connection:

Hand loosen/tighten screw

28. Washing arm type:

Rotating trident

Technical data sheet

Technical parameters



Pot and pan washer double skin with drain pump heat recovery system 70x70 - 400 V

Model	SAP Code	00011974
S 202 REC ABT	A group of articles - web	Undercounter, continuous and black ware dishwasher

29. Washing arm material:

Stainless steel

30. Atmospheric boiler with rinse pump:

Yes

31. Rinsing arm type:

Rotating trident

32. Rinsing arm material:

Stainless steel

33. Deep drawn tank:

Yes

34. Rack support:

Pressed

35. Tank surface strainers:

stainless steel

36. Drain filter:

Evolution3 - double filtration with electronically controlled partial discharge before the rinsing phase ensures 0% loss of clean water to waste

37. Thermostop:

Yes

38. Boiler thermostat adjust:

Yes

49. USB port:

Yes, for Firmware actualisation

39. Detergent and rinse pump system:

ProDose - accurate dosing with a peristaltic pump

40. Energy Saving system:

EnergySaving - Energy saving system due to lowering the boiler temperature

41. Rinse system:

UltraRinse2 - stainless steel rinsing arms including stainless steel nozzles with a geometry for spraying water in thin jets directly against the dishes, the rinsing pump ensures constant pressure

42. Heating system:

HotWash - System of simultaneous operation of the heating element of the bath and the boiler, reducing the time for starting the next cycle

43. Quick heating system:

QuickReady - System for rapid heating of water in the tank

44. Heat recovery:

1 copper-aluminum battery - saving up to 40% of the energy needed to heat the water in the boiler, at the same time, by absorbing the released steam, it eliminates the need to use a hood

45. Hot water electric valve:

Yes

46. Closing door system:

ProSoft - Reduces noise, dampens the door stop, which could cause damage to dishes

47. Rack size [mm]:

700 x 700

48. Display type:

LCD multifunction display

60. Program ProFessional 8:

Yes

Technical data sheet

Technical parameters



Pot and pan washer double skin with drain pump heat recovery system 70x70 - 400 V

Model	SAP Code	00011974
S 202 REC ABT	A group of articles - web	Undercounter, continuous and black ware dishwasher

50. Drain pump:

Yes

51. Self-diagnostics:

Yes

52. Wash pump type:

two-way - DuoFlow

53. Detergent dispenser:

Yes

54. Rinse aid dispenser:

Yes

55. Water consumption of the washing cycle [l/basket]:

4

56. Rinse water temperature [°C]:

80-85

57. Program ProFessional 2:

Yes

58. Program ProFessional 4:

Yes

59. Program ProFessional 6:

Yes

61. Program ProFessional 10:

Yes

62. Program ProClean:

Yes

63. Program ProDrain:

Yes

64. Program ProEco:

Yes

65. Program ProLong:

Yes

66. Program ProActive 5:

Yes

67. Program ProActive 7:

Yes

68. Cross-section of conductors CU [mm²]:

5

69. Water supply connection:

3/4"

70. Diameter nominal:

DN 50